

Mechanical:

| REV. | ECN NO. | DESCRIPTION | DATE | APPD |
|------|---------|-------------|------------|------|
| A | REL | | 2013-12-27 | |

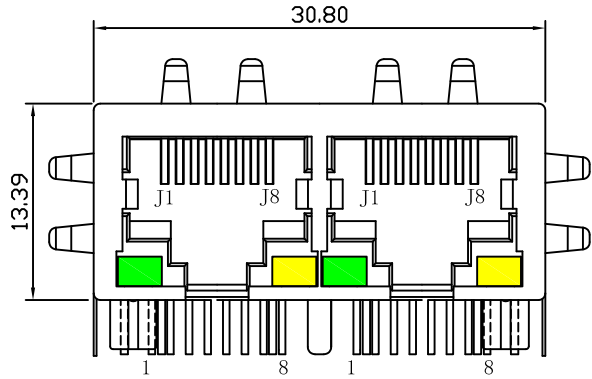

Front Side View

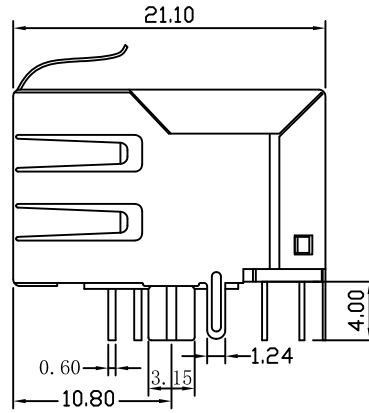

Left Side View

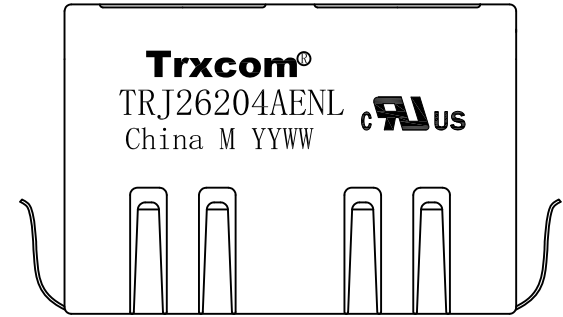

Top Side View

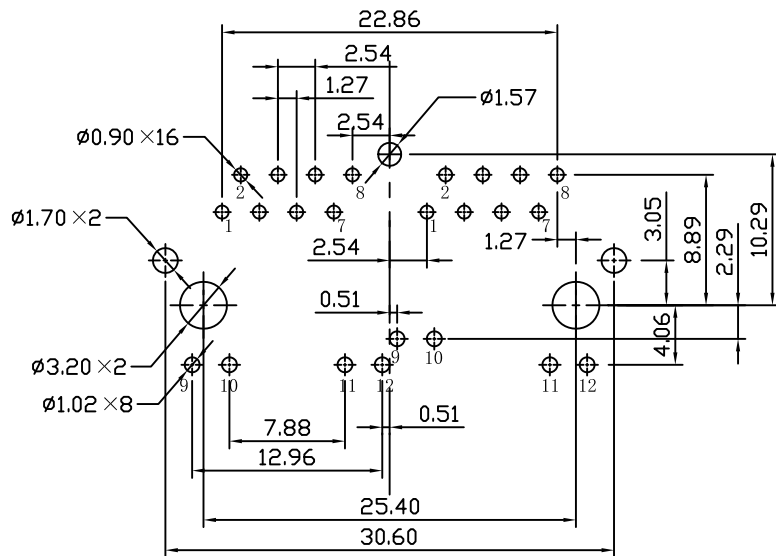

Suggested PCB Layout (Top View)



NOTES:

1. Designed to support application, such as SOHO (ADSL modems), LAN-on-Motherboard (LOM), hub and Switches.
2. Meets IEEE 802.3 specification
3. Connector Materials:
 Housing: Thermoplastic PBT+30%G.F UL94V-0
 Contact: Phosphor Bronze C5210R-EH Thickness=0.35mm
 Pins: Brass C2680R-H Thickness=0.35mm
 Shield: SUS 201-1/2H Thickness=0.2mm
 Contact plating: Gold 6 micro-inches min. In contact area.
4. Wave solder tip temperature: 265°C Max
 Wave solder tip temperature time: 5 Sec Max
5. UL Certification: File Number E321120

| | | |
|-------------|------------|---|
| X:X ±0.25 | APPD: | Trxcom Huizhou Trxcom Electronics Co., Ltd. |
| X:XX ±0.20 | CHKD: | |
| X:XXX ±0.05 | DR: GRANT | TITLE: 1*2 RJ45 Connector with 10/100 Base-T Integrated Magnetics |
| ANGLES ±1° | UNIT: mm | PART NO.: TRJ26204AENL |
| | SCALE: 2/1 | SHEET: 1/2 |
| | REV: A | DWG NO.: TRC13122712 |

Schematic:

| REV. | ECN NO. | DESCRIPTION | DATE | APPD |
|------|---------|-------------|------------|------|
| A | REL | | 2013-12-27 | |

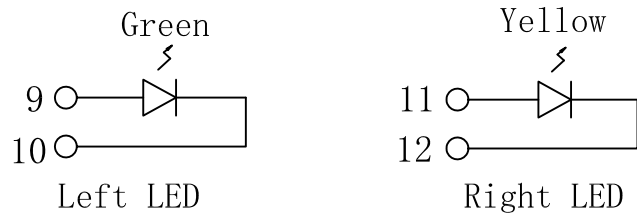
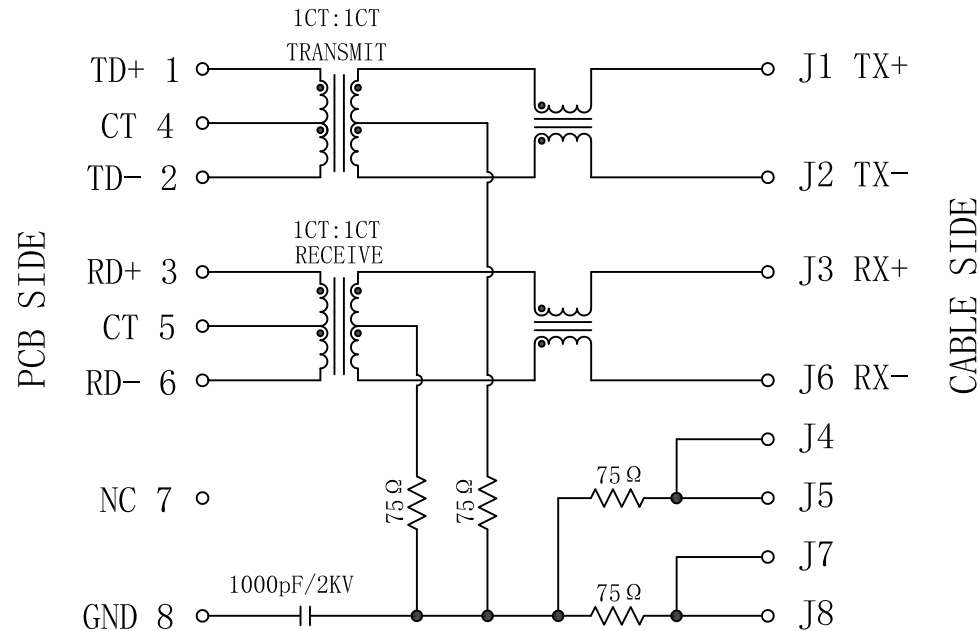

| Emitting Color | λ p(nm) | VF@IF=20mA | IR @VR=5V |
|----------------|-----------------|------------|----------------|
| Green | 565 | 1.8~2.4V | 10 μ A max |
| Yellow | 585 | 1.8~2.4V | 10 μ A max |

ELECTRICAL SPECIFICATIONS @25°C

- Turn Ratio ($\pm 3\%$):
TX=1CT:1CT RX=1CT:1CT
- Inductance OCL:
350uH MIN @ 100KHz 0.1V 8mA DC Bias
- DCR: 1.2 Ω MAX
- Insertion Loss:
-1.0dB MAX @ 1-100MHz
- Return Loss:
-18dB MIN @ 1-30MHz
-15dB MIN @ 30-60MHz
-12dB MIN @ 60-100MHz
- Cross talk:
-40dB MIN @ 30MHz
-35dB MIN @ 60MHz
-30dB MIN @ 100MHz
- Common Mode Rejection:
-30dB MIN @ 1-100MHz
- Hipot Test: 1500Vrms
- Operating Temperature Range: 0°C TO 70°C



| | | | | |
|--------|---------------|------------|---|----------------------|
| X:X | ± 0.25 | APPD: | Trxcom | |
| X:XX | ± 0.20 | CHKD: | Huizhou Trxcom Electronics Co., Ltd. | |
| X:XXX | ± 0.05 | DR: GRANT | TITLE: 1*2 RJ45 Connector with 10/100 Base-T Integrated Magnetics | |
| ANGLES | $\pm 1^\circ$ | UNIT: mm | PART NO.: TRJ26204AENL | |
| | SCALE: 2/1 | SHEET: 2/2 | REV: A | DWG NO.: TRC13122712 |

Profile of wave solder:

| REV. | ECN NO. | DESCRIPTION | DATE | APPD |
|------|---------|-------------|------------|------|
| A | REL | | 2013-12-27 | |

SUGGESTED PROFILE OF WAVE SOLDER FOR ROHS PRODUCT

REV: A

TEMP(°C): 25

HUM(%): 65 RH

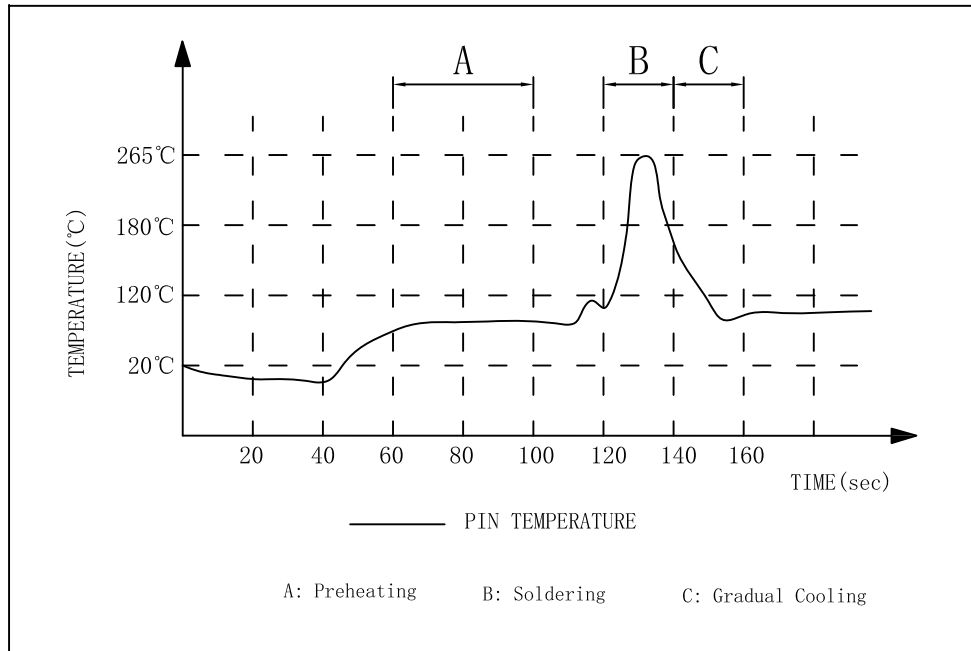

- (1) Tip Temperature: 265°C max
 - (2) Tip Temperature time: 5sec max
- Note: The melting point of Tin: 219°C

| | | |
|-------------|------------|---|
| X:X ±0.25 | APPD: | Trxcom |
| X:XX ±0.20 | CHKD: | |
| X:XXX ±0.05 | DR: GRANT | TITLE: 1*2 RJ45 Connector with 10/100 Base-T Integrated Magnetics |
| ANGLES ±1° | UNIT: mm | PART NO.: TRJ26204AENL |
| | SCALE: 2/1 | SHEET: 1/2 |
| | REV: A | DWG NO.: TRC13122712 |

Packaging:

| REV. | ECN NO. | DESCRIPTION | DATE | APPD |
|------|---------|-------------|------------|------|
| A | REL | | 2015-12-27 | |

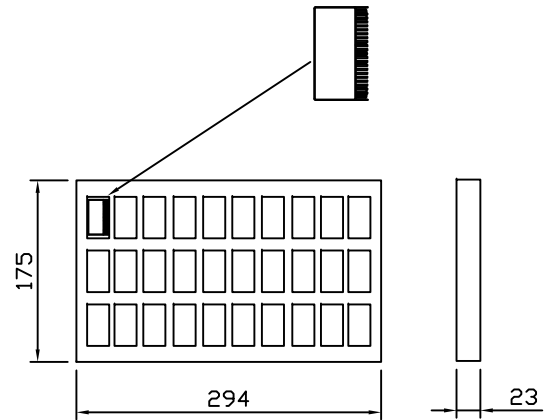

20Tray →

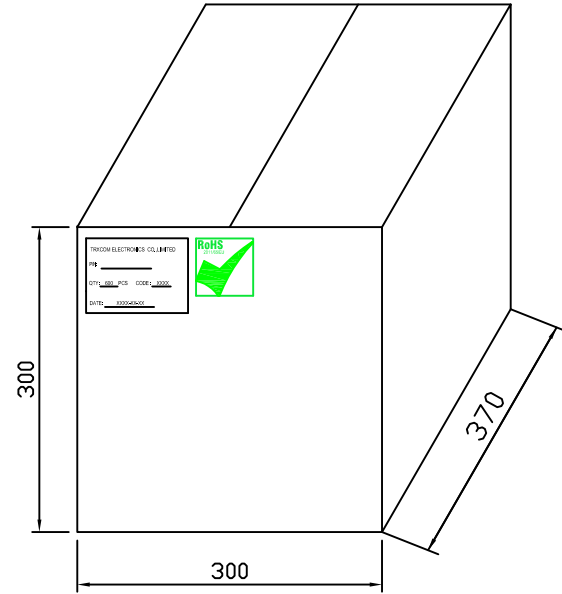

- ◆ Packaging unit :30pcs/tray
- ◆ Packaging material:PVC
- ◆ Outer carton unit:600pcs/20tray/box
- ◆ Net Weight:8kg
- ◆ Gross Weight:10kg

| | | | | |
|--------|-------|------------|------------------------------------|-------------|
| X:X | ±0.25 | APPD: | Trxcom | |
| X:XX | ±0.20 | CHKD: | Huizhou Trxcom Electronics Co.,ltd | |
| X:XXX | ±0.05 | DR: GRANT | TITLE: 1*2 21.3 RJ45 PACKING | |
| ANGLES | ±1° | UNIT: mm | PART NO.: TRJ26204AENL | |
| | | SCALE: 2/1 | SHEET: 4/4 | REV: A |
| | | DWG NO.: | | TRC13112712 |