

FEATURES

- ※ Sealed
- ※ Reflow solderable
- ※ Dust proof with high reliability

APPLICATION

- ※ Audio, OA equipment
- ※ Instrumentation, Communication
- ※ White goods

SPECIFICATION

Contact Rating	50mA, 12V DC
Contact Resistance	100mΩ max.
Insulation Resistance	100MΩ min. 500V DC
Dielectric Strength	250V AC/1 minute
Operating Force	160±50gf, Brown(N) 66/677 160±50gf, Silver(S) 68 180±50gf, Brown(N) 69/67/65/64 260±70gf, Red(R) 69/67/66/65/64 360±90gf, Transparent(T) 69/67/65/677
Travel	0.25mm 68S/66N/66R/677 0.45mm (69/67N,R)(65/64N,R,T) 0.6mm 69/67T
Operating Life	100,000 cycles min. for 68/66/677 500,000 cycles min. for 69/67/65/64
Operating Temp.	-25°C ~ +70°C
Storage Temp.	-30°C ~ +80°C

HOW TO ORDER

**DTS W - 6** [ ] [ ] - [ ] - [ ]

M=S.M.T.  
GM=S.M.T. & With Ground Pin (66 Only)

Washable

Package:  
B=Tube  
T/R=Tape & Reel

V=RoHS & Lead Free Solderable  
Q=Halogen Free

Operating Force:  
N=Brown, 160gf(66N, 677N)  
180gf(69N, 67N, 65N, 64N)  
S=Silver, 160gf(68S)  
R=Red, 260gf(69R, 67R, 66R, 65R, 64R)  
T=Transparent, 360gf(69T, 67T, 65T, 677T)

Dimension H:  
4=4.50mm (N, R)  
5=3.50mm (N, R, T)  
6=3.10mm (N, R)  
7=5.20mm (N, R, T)  
77=7.30mm (N, T)  
8=2.30mm (S)  
9=3.80mm (N, R, T)

CIRCUIT

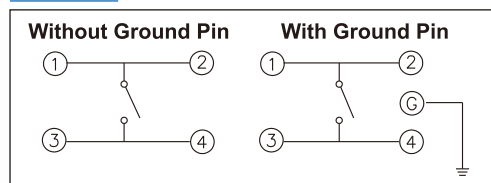

PACKAGE

- <Tube>  
75 pcs
- <Tape & Reel>  
DTSGMW-66: 2000 pcs  
DTSMW-68, 66: 2000 pcs  
DTSMW-69, 65: 1900 pcs  
DTSMW-67, 64: 900 pcs  
DTSMW-677: 650 pcs

DTSGMW-66

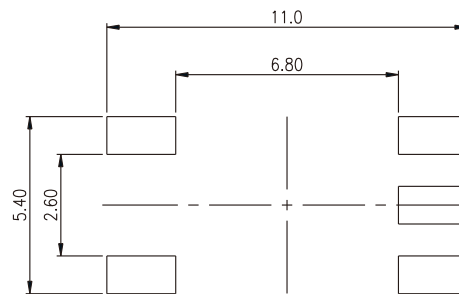
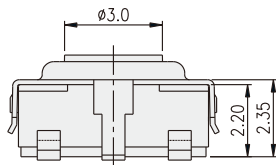
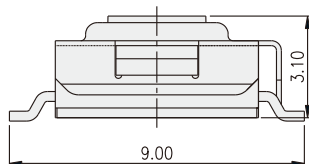
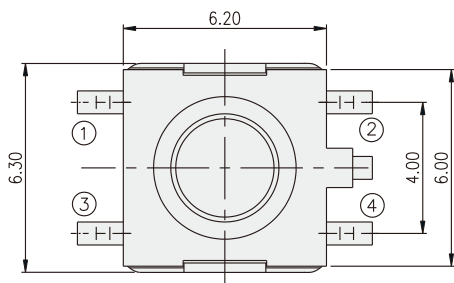

P.C.B. LAYOUT

TACT SWITCH  
**DTS(G)MW-6 SERIES**

6x6 Gull-Wing SMT  
 Washable Type



**DTSMW-68**

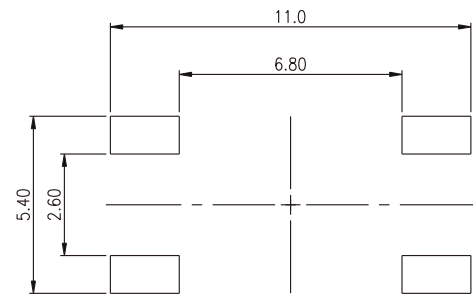
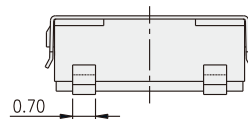
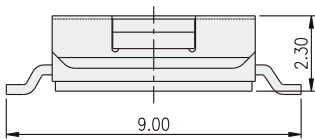
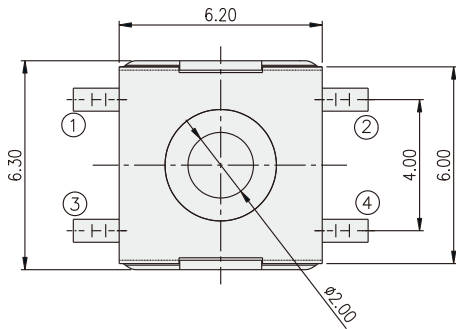

P.C.B. LAYOUT

TACT SWITCH

**DTSMW-6** □

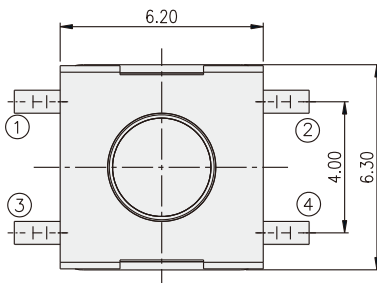

PART NO.	H
DTSMW-64	4.50
DTSMW-65	3.50
DTSMW-67	5.20
DTSMW-69	3.80
DTSMW-677	7.30

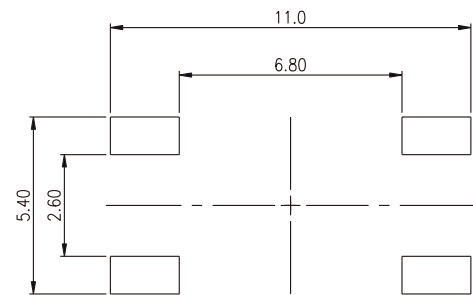
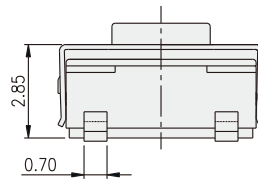
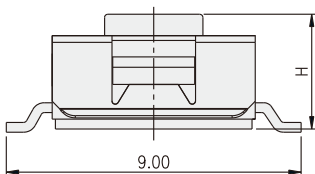

P.C.B. LAYOUT